

Soledad, South Side  
North side on separate map

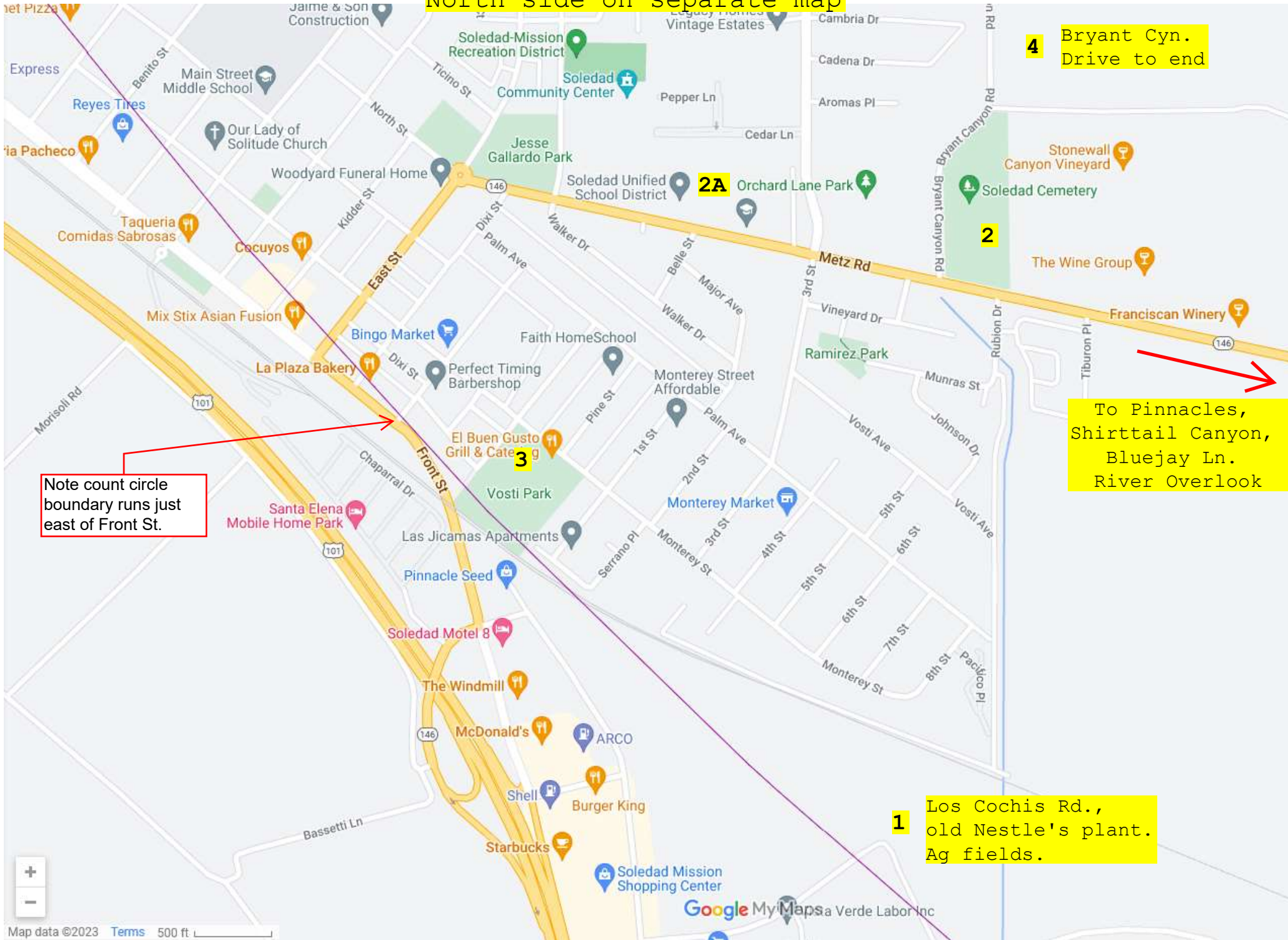

4 Bryant Cyn.  
Drive to end

2A

2

3

Note count circle  
boundary runs just  
east of Front St.

To Pinnacles,  
Shirttail Canyon,  
Bluejay Ln.  
River Overlook

1

Los Cochis Rd.,  
old Nestle's plant.  
Ag fields.

Soledad, North Side  
South Side on separate map

Numbering starts at 1 on south side map

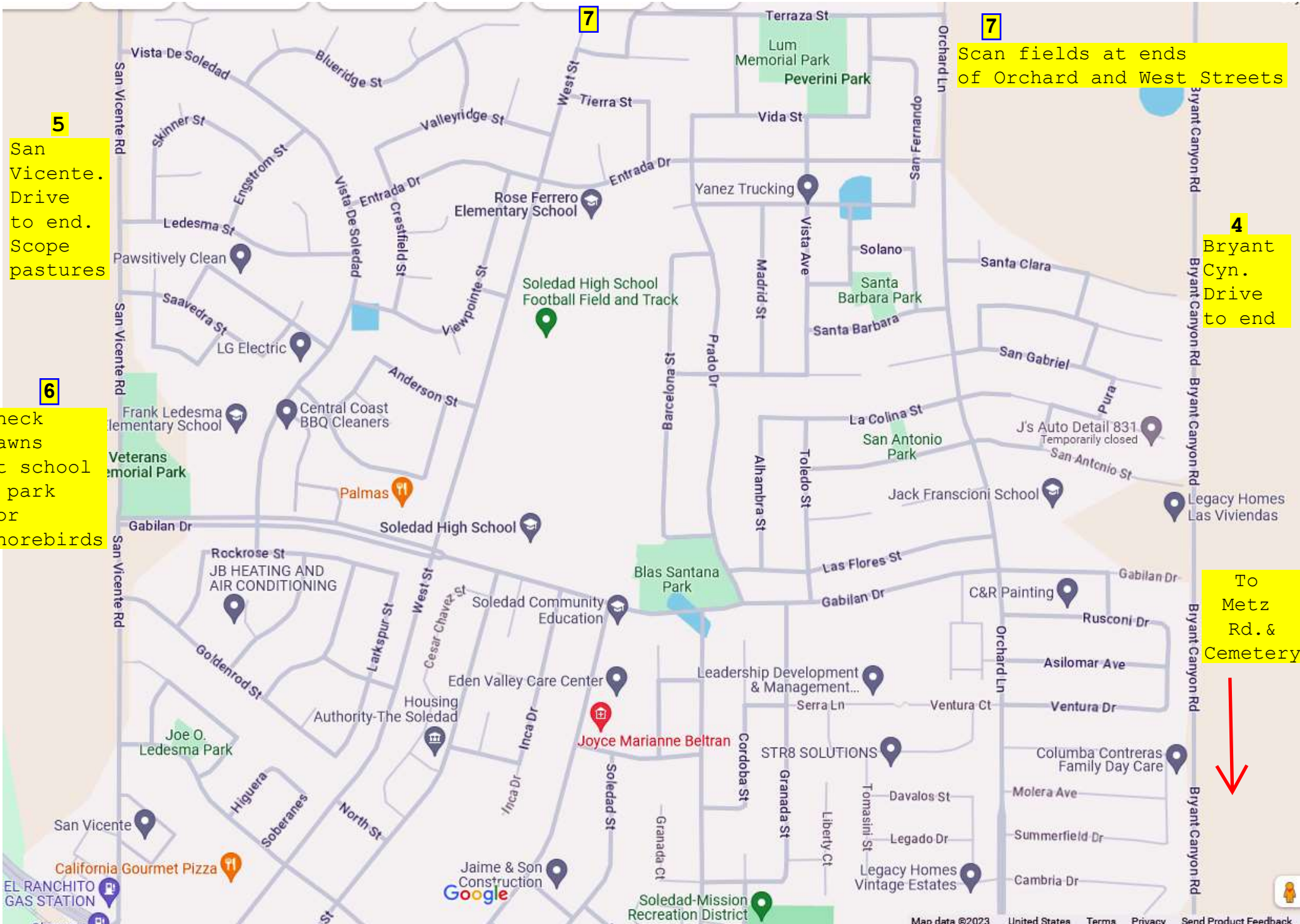

5  
San Vicente.  
Drive to end.  
Scope pastures

6  
Check lawns  
at school  
& park  
for shorebirds

7  
Scan fields at ends  
of Orchard and West Streets

4  
Bryant Cyn.  
Drive to end

To Metz Rd. & Cemetery



Soledad Map Key  
12/27/2023

South Map

The power lines in town are usually loaded with Collared-doves, blackbirds, starlings, occasionally grackles. Stop and count.

1. Los Cochis Rd. east of shopping center. The old Nestle's plant is just inside the count circle. Raptors, sparrows, finches, etc. in the ag. fields nearby.
2. Cemetery. Usually good for a variety of small birds.
- 2A. Schools and Parks adjacent to cemetery. Sometimes shorebirds on the lawns.
3. Vosti Park. Usually a few birds of interest on the lawn or in the trees. Sometimes unusual birds (Phainopepla, warblers, creeper, pipits, snipe).
4. Bryant Canyon Rd. Runs about 1.5 miles to road's end at private property. Fields, vineyards, eucalyptus windbreaks, houses. Sometimes Horned Larks on any bare ground. Sometimes Mountain Bluebirds in the vineyards. Juncos in the conifers at the end of the road near the truck yard.

North Map

4. Bryant Canyon. See south map above.
5. San Vicente Rd. From Veteran's Park, runs about 2 miles to the end of the road. Mostly country; fields, vineyards, windbreaks. At the end of the road, scope the pastures for ground birds (Horned Larks, Pipits) and scan the sky and the power towers for raptors.
6. Veteran's Park, Ledesma School. Scan the lawns and athletic field for shorebirds. This holds true for all the schools and parks in town, but this particular area seems especially reliable.
7. Orchard Ln. and West St. Orchard Lane does (or did, before development) run alongside some bare lots and fields. Sometimes birds of interest in these sections. If time permits, drive to the ends of both of these streets and scan the field beyond the houses.